



## Case History TRANSFER STATION UPGRADE

**SPERLING  
HANSEN  
ASSOCIATES**

### Design Project, City of Vancouver

- *City of Vancouver is Upgrading Entrance and Transfer Station/Recycling Facilities*
- *Project was part of Closure Design a portion of the landfill*
- *SHA designed conceptual layout of Entrance, Recycling Area, Scale Facility and Free Recycling Drop Off Area.*
- *Project currently under design review.*

*City of Vancouver Contact: Paul Henderson  
Project Budget \$20,400*

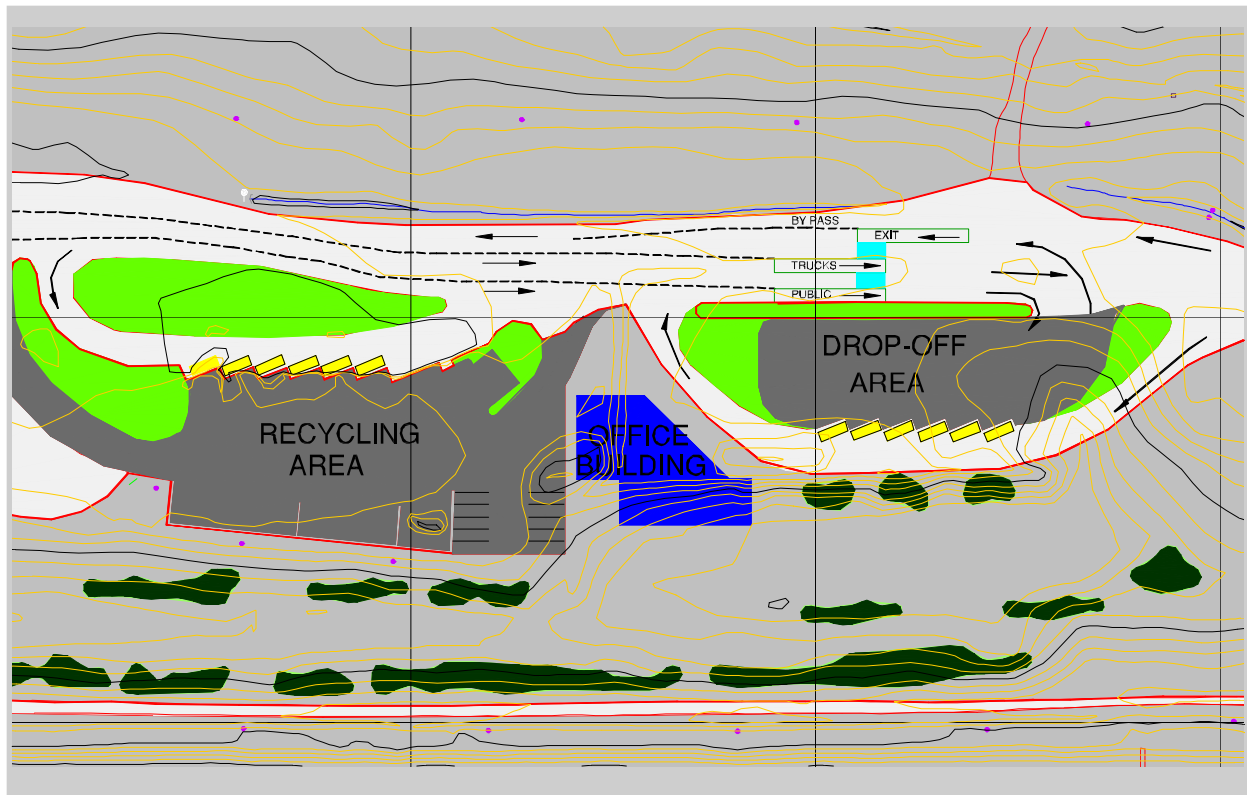

**SPERLING HANSEN ASSOCIATES**  
#8 1225 East Keith Road, North Vancouver, B.C.  
Phone (604) 986-7723 Fax (604) 986-7734  
E-Mail: [sperling@sperlinghansen.com](mailto:sperling@sperlinghansen.com)

- *Landfill Siting*
- *Landfill Closure*
- *Hydrogeological Investigation*
- *Environmental Monitoring*
- *Design and Operations Plans*